

# Thermal Overload Relays

## "NTH"-Series 0.35A to 44A

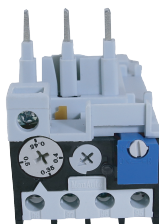

### THERMAL OVERLOAD RELAYS

Compensated and differential overload relays

With 1 N/O + 1 N/C electrically separated auxiliary contacts

For direct connection with "C and SMC"- series contactors

Model Name	Relay Setting Range RC (FLC) A	Contactor Type	Weight Kg	Approval	Motor Capacity (HP)				
					1 phase		3 phase		
					100-110V	200-220V	200-220V	380-440V	500-550V
NTH-0.5	0.35 - 0.5A	C-09D,SMC-09	0.14	CE, UL, IEC, CCC				0.125	
NTH-0.75	0.5 - 0.75A	C-09D,SMC-09	0.14	CE, UL, IEC, CCC			0.125	0.25	
NTH-1.05	0.75 - 1.05A	C-09D,SMC-09	0.14	CE, UL, IEC, CCC					0.5
NTH-1.45	1.05 - 1.45A	C-09D,SMC-09	0.14	CE, UL, IEC, CCC			0.25	0.5	1
NTH-1.9	1.4 - 1.9A	C-09D,SMC-09	0.14	CE, UL, IEC, CCC		0.125	0.75		
NTH-2.5	1.9 - 2.5A	C-09D,SMC-09	0.14	CE, UL, IEC, CCC	0.25	0.5	1	1.5	
NTH-3	2.4 - 3A	C-09D,SMC-09	0.14	CE, UL, IEC, CCC			1.5	2	
NTH-4	2.9 - 4A	C-09D,SMC-09	0.14	CE, UL, IEC, CCC	1/8	0.5	1	2	
NTH-5	3.8 - 5A	C-09D,SMC-09	0.14	CE, UL, IEC, CCC	1/4	0.75	3	3	
NTH-6.5	4.5 - 6.5A	C-09D,SMC-09	0.14	CE, UL, IEC, CCC	1/2	0.75	1.5	5	
NTH-8	6 - 8A	C-09D,SMC-09	0.14	CE, UL, IEC, CCC	1/2	1	2	5	
NTH-11	8 - 11A	C-11D,SMC-09	0.14	CE, UL, IEC, CCC		1.5	3	5	
NTH-14	11 - 14A	C-12D,SMC-12	0.14	CE, UL, IEC, CCC	0.75	2	4	7.5	10
NTH-15	10 - 15A	C-12D,SMC-18	0.14	CE, UL, IEC, CCC	0.75	2	4	7.5	10
NTH-17	14 - 17A	C-12D,SMC-18	0.14	CE, UL, IEC, CCC	1	2	5	10	15
NTH-21	17 - 21A	C-18D,SMC-22	0.15	CE, UL, IEC, CCC	1.5	3	15	20	
NTH-25	21 - 25A	C-18D,SMC-32	0.15	CE, UL, IEC, CCC	2	4	7.5	20	
NTH-28	24 - 28A	C-25D,SMC-32	0.15	CE, UL, IEC, CCC				20	
NTH-32	26 - 32A	C-25D,SMC-32	0.15	CE, UL, IEC, CCC		5	10	25	
NTH-38	30 - 38A	C-35D,SMC-40	0.18	CE				25	30
NTH-44	36 - 44A	C-35D,SMC-40	0.18	CE		7.5	15	30	40

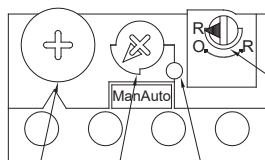

Setting current button  
Setting lever  
Man & Auto button  
Switching position indication

Button for reset and disconnection -setting: O/R or R;  
O/R=reset and disconnection  
R=reset only

Knob for changing to "reset". Function depends on the position of the reset button.

1. MAN-position  
A. MAN-position and reset button on position R.

The blue reset button is for manual reset only. Accidental pushing of the reset button of the untripped relay does not result in any contact function.

B. MAN-position and reset button on position O/R.

The blue reset button is for manual reset and it can be used as a STOP-button as well. Contact 95-96 open while pressing the reset button.

2. AUTO-position

A. AUTO-position and reset button on position R.

The tripped relay will automatically reset itself after approx. 1 min.

B. AUTO-position and reset button on position O/R.

The tripped relay will automatically reset itself after approx. 1 min.

The blue reset button is used only as a STOP-button. Contact 95-96 open while the reset button is pressed.

Note : Select and set the overload relay according to the current value on the motor rating plate. Direct mounting on the underside of the contactors.

Terminals protected against direct finger contact and fitted with ready to tighten screws. Lockable and sealable Man/Auto switch.

Trip Test. Cover locks the function.

# "NTH"- Series Thermal Overload Relays

## Dimensions(mm)

### NTH-Series

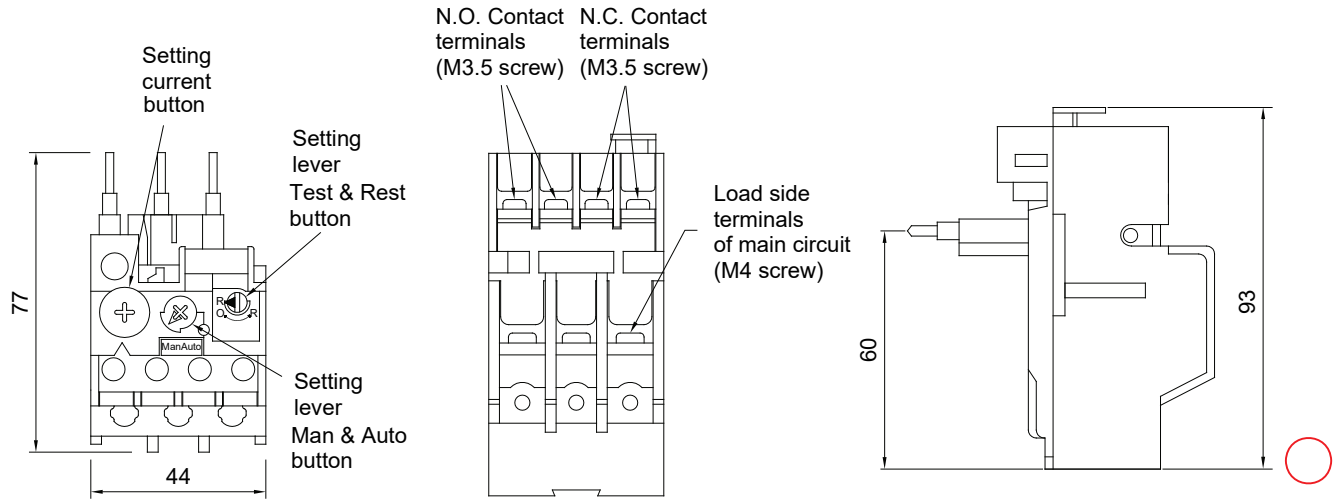

### NTH-04 Separate Blocks

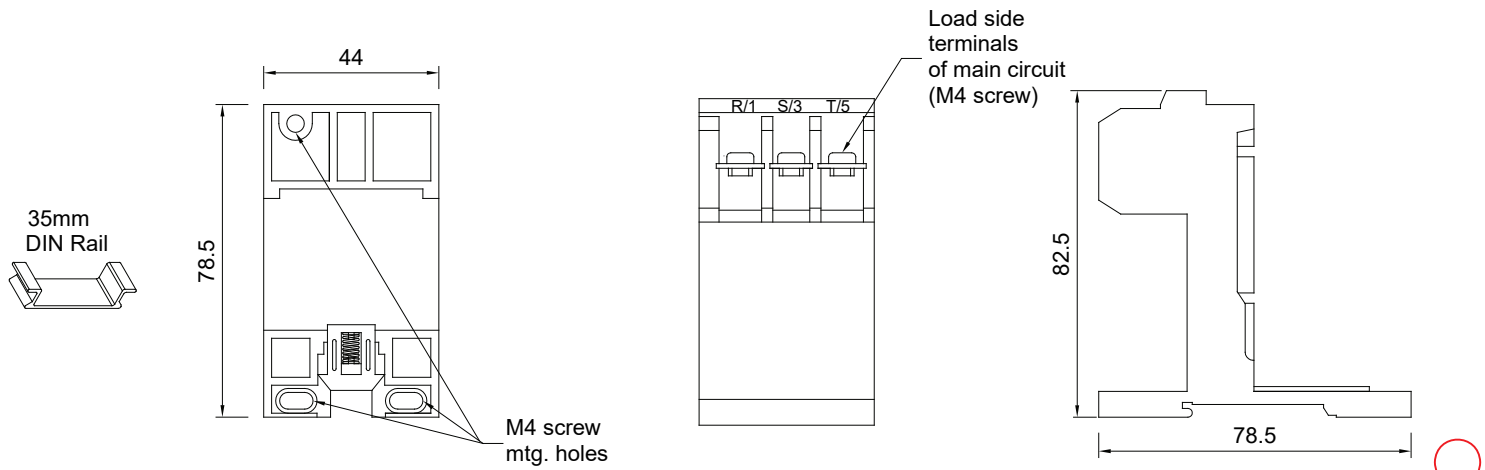

### NTH+NTH-04

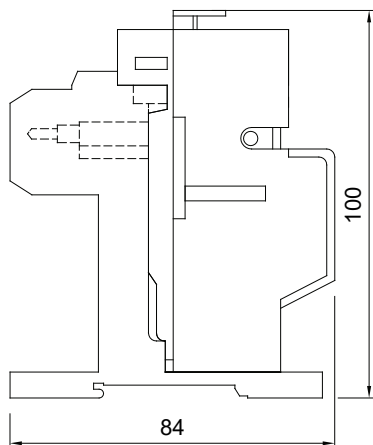

### NTH-51 Rear connector

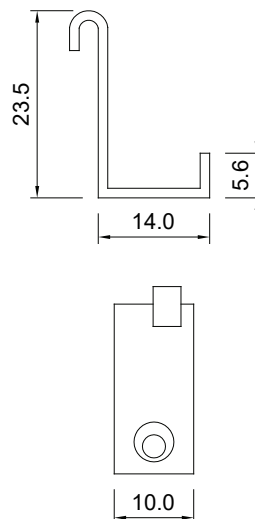

### NTH+NTH-51 (C-25D.C-35D only)

